



apomare

OVERMARINE MANGUSTA 80 (2006)



OVERMARINE MANGUSTA 80 (2006)

MANGUSTA



970.000 EURO











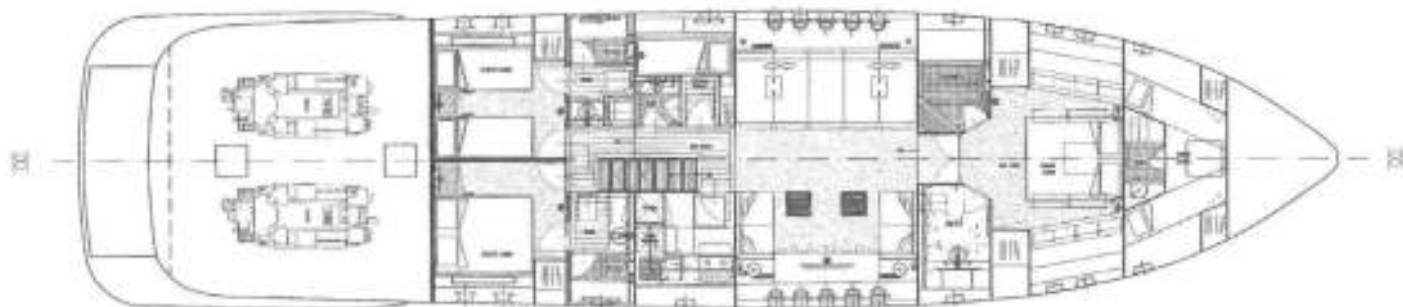
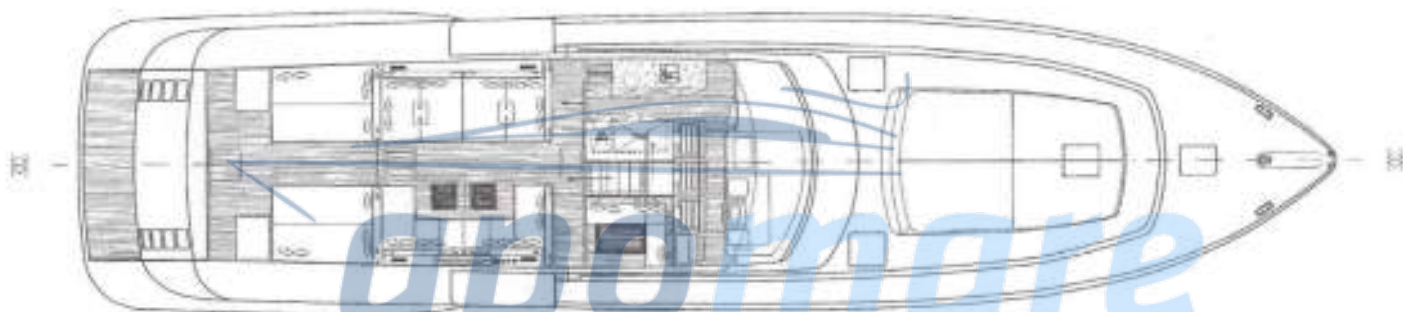

apomare

DIMENSIONI PRINCIPALI		
MM (DIMENSIONI)		
Lunghezza IT	23200	823 0
Lunghezza SA		
Lunghezza FT	20000	656 0
Max. largh. CA		
Max. largh. FT	5000	164 0
Max. largh. CA		
Displacement Netto/Grigio		
Max. Load/Displacement		28 %



	MY MANGUSTA 807 Open		
	DIMENSIONI PRINCIPALI DIMENSIONI (MM)		
Data: 21/03/2008 Disegnato:	Scala: 1:40	Foglio: 01	Nome: 0100006304

OVERMARINE MANGUSTA 80 (2006)

BUILDER: OVERMARINE MANGUSTA 80'

LOA: 23.95M

YEAR: 2006

BEAM: 6.00M

DRAFT: 1.15M

CRUISE SPEED: 38,00 KNOTS

TOP SPEED: 46.00 KNOTS

ACCOMMODATION: 6 GUESTS/3CABINS

HULL: FIBERGLASS

ENGINES: MTU 16V2000M92-2X2180HP



MAIN SPECIFICATION

SCHEDA TECNICA IMBARCAZIONE / Technical data

CANTIERE/Yard..... Cantiere Overmarine Italy

MODELLO/Model Mangusta 80Ht. #63

ANNO DI COSTRUZIONE/ Building year 2006

REGISTRAZIONE/ Commercial registration R.I.N.A class

NAVIGAZIONE/ Navigation range Unlimited

RIALLESTIMENTI/ Refits-upgrade..... 2011

SCAFO/Hull Grp

SOVRASTRUTTURA/Superstructure.....	Grp
LUNGHEZZA/L.O.A.	25,70mt.
LARGHEZZA/Beam.....	6,00mt.
PESCAGGIO/Draft.....	1,15mt.
DISLOCAMENTO/Displacement.....	58 tons.
MOTORE/Engine	Mtu 16V 2000M92- 2x2180hp common rail
ORE MOTO/Engine hours	960h.
CONSUMO Vel. crociera/Consumption Crux. Speed.....	450L/h
AUTONOMIA/ Range.....	350nm. (32knots)
ELICA DI PRUA/Bow thruster.....	Yes
ELICA DI POPPA/Stern thruster	
STABILIZZATORI/Stabilizers	
TRASMISSIONE/Trasmission.....	Arneson ASD 15
VELOCITA' MAX/Top speed	46,0 knots
VELOCITA' CROCIERA/Cruising speed.....	38,0 knots
CARBURANTE/Fuel	Diesel
SERBATOIO CARBURANTE/Fuel capacity.....	Lt. 6000
IMPIANTO ELETTRICO/Electric wire.....	12 /24/220Volts
CARICABATTERIA/Battery charger.....	Yes
ARIA CONDIZIONATA/Air conditioning	Yes
DISSALATORE/Watermaker	Yes
GENERATORE/Generator	Kohler 2x20Kw.
SERBATOIO ACQUA/ Fresh water capacity	Lt. 1300

SERBATOIO ACQUE NERE/Black water tank	Yes
RADAR/Radar	Furuno
PILOTA AUTOMATICO/Autopilot.....	Raymarine ST 8001
GPS	Raymarine E120
VHF	Raymarine
ECO	Raymarine
ANTENNA SATELLITARE/Satellite comm.....	Yes
TV, SATELLITARE/ Satellite TV.....	Yes
IMPIANTO HI-FI/ Hi-Fi entertainment	Yes
PASSERELLA IDRAULICA/Hidraulic gangway	Yes
Tender	Novamarine Water jet
CABINE DOPPIE/Double cabin	3 (6 berths)
BAGNI/Bathrooms	4
EQUIPAGGIO/Crew	1 (2 berths)
ORMEGGIO/Mooring.....	Puglia Italy



www.apomare.com

info@apomare.com

+90(532) 211 50 05